

**Cheshire Suite**

160 guests

The Cheshire Suite can accommodate 160 guests and is a bright modern room that has the benefit of a separate entrance, reception area and exclusive bar. The Cheshire Suite also has its own private kitchen area so is available for outside catering events.

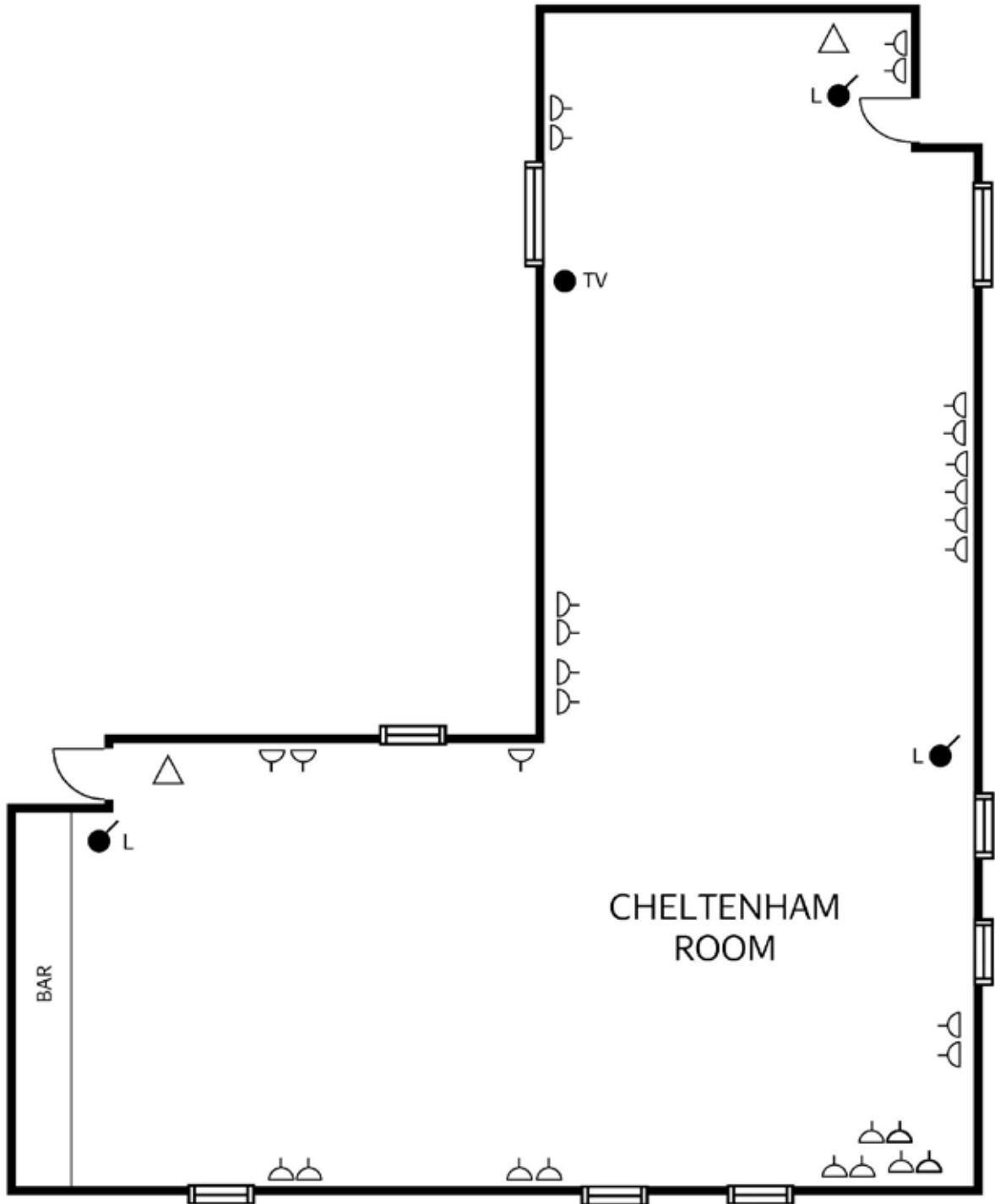

### **Cheltenham Suite**

110 guests

The Cheltenham Suite is a stylish room with natural daylight that has a fresh feel, finished in warm tones with an elegantly stylish ambience. The Cheltenham Suite is part of the farmhouse that originally stood on the site and boasts original ceiling beams and character. The suite can accommodate up to 110 guests on round tables and features its own exclusive bar.

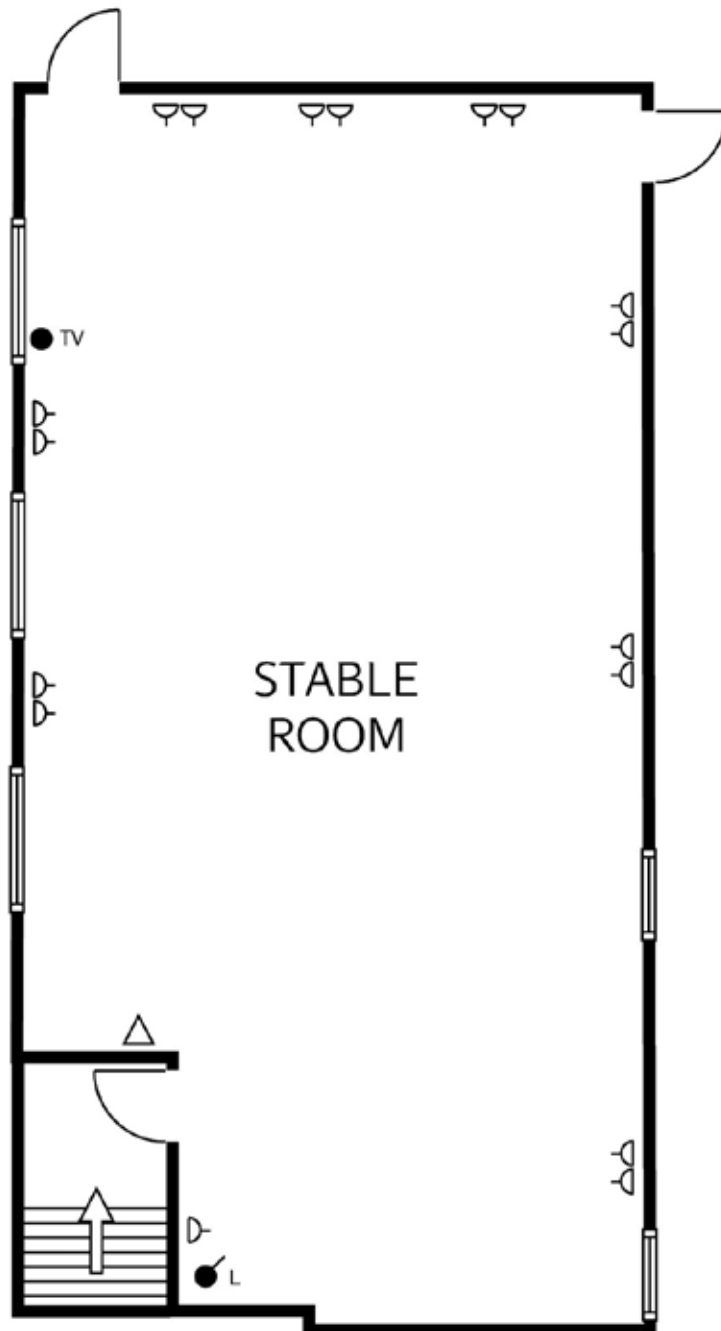

**Stable Suite**

60 guests

A stylish suite adjacent to the Cheltenham Suite in the original part of the building with exceptional flair, warmth and intimate lighting to enhance your event. The Stable Suite is ideal for ceremonies, private smaller receptions or as additional room for your evening reception.

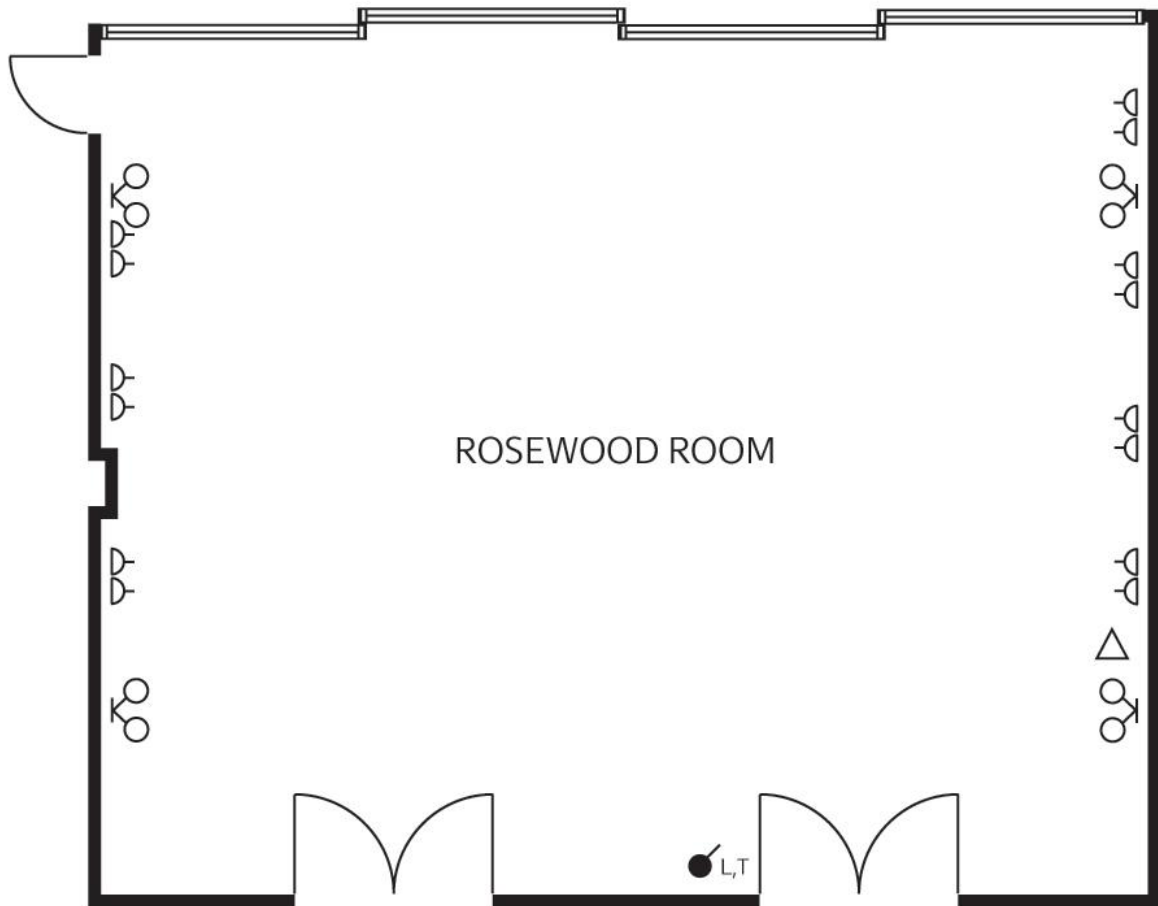

**Rosewood Suite**

60 guests

The Rosewood Suite is ideal for ceremonies, vow renewals and small intimate events. The Suite is bathed in natural daylight with picture windows overlooking the beautiful landscaped gardens. The Rosewood features access onto the courtyard through patio doors making it ideal for spilling out into the gardens in the summer months.